

# Metro - Nylon Base



Featured with arms

## DESCRIPTION

A stylish mesh back chair offering a modern look for your office your office, featuring superior seat comfort and a full range of adjustable ergonomic features.

The Buro Metro chair is supported by the following internationally recognised standards:

- 'AFRDI Level 6 - Severe Commercial Certification'
- Global GreenTag<sup>CERT™</sup>

## SPECIFICATIONS

Buro guaranteed to: 150kg

Buro indicative daily sitting hours: 8+

Overall size (mm): 630w x 995h x 610d

Back size (mm): 470w x 530h

Seat size (mm): 520w x 490d

Seat height (mm): 465-595

Seat depth range without seat slide<sup>2</sup> (mm): 475

Seat depth range with seat slide<sup>2</sup> (mm): 455-505

Seat height with seat slide<sup>2</sup> (mm): 485-605

## FEATURES

- Adjustable seat height
- Ratchet height adjustable back/lumbar
- Independently adjustable seat tilt
  - free floating or lockable
- Independently adjustable back tilt
  - free floating or lockable
- High density polyurethane moulded foam seat
- Black nylon base
- Meets Australian/New Zealand Standard AS/NZS 4438:1997 – Height Adjustable Swivel Chairs
- Supported by the internationally recognised Global GreenTag<sup>CERT™</sup>

## OPTIONS

- Customer specified fabric (seat only)
- Height and width adjustable arms (180-2)
- Polished aluminium base (PC068)
- Soft PU castors (PC016)
- Depth adjustable seat slide (PC075)
- Small Seat 480W x 470D (mm) (B74612F)

## BURO QUALITY ASSURANCE

Manufactured in an ISO9001 & ISO14001 certified factory



<sup>2</sup>Guarantee conditions apply, please see [buroseating.com.au](http://buroseating.com.au). For indent purchases (non stock orders) conditions may apply, please see [buroseating.com.au](http://buroseating.com.au) for definitions & conditions.  
In the interests of product development, Buro reserves the right to alter product specifications & features without notice.

Zen



103 Black

[buroseating.com.au](http://buroseating.com.au)

## Material Analysis

Buro Seating acknowledges its responsibility to develop environmentally sustainable products and business practices and consequently is committed to growing our range of chairs which are manufactured from recycled and/or recyclable materials. Buro's environmental management system (EMS) provides the framework for managing our environmental strategy;

### MAIN PRINCIPLES

- To design products and processes that utilize minimal raw materials.
- To design products with a minimum end of life recyclability of 95% in NZ and Australia.
- To reduce, reuse and recycle waste.
- To develop an understanding of legislation relating to the environment and affecting the activities of our company.

Buro is committed to developing a "cradle to grave" process for all seating products wholesaled in NZ and Australia.

### METRO CHAIR - NYLON BASE

MATERIAL TYPE	CHAIR COMPONENT	% RECYCLED CONTENT	% RECYCLABLE AFTER USE
Plastic (33.5%)	• Paddles/Plugs/Tips (0.3kg)	50%	98% Recyclable
	• Seat Pan (0.6kg)	50%	
	• Back Bellows (0.08kg)	50%	
	• Castors (0.56kg)	90%	
	• Back Outer Frame (2.5kg)	50%	
	• Chair base (1.8kg)		
Steel (50.8%)	• Screws & Bolts (0.5kg)	0%	
	• Seat Mechanism (5.45kg)		
	• Gas Lift & Support Tube (1.1kg)		
	• Back Post & Bracket (1.8kg)		
Plywood (10.3%)	• Seat Plywood (1.8kg)	0%	
Foam (3.4%)	• PU Seat Foam (0.58kg)	0%	
Upholstery (2%)	• Upholstery Fabric (0.35kg)	0%	2% Non-Recyclable
Packaging (100%)	• Cardboard Carton & Internal Packaging (1.0kg)	88%	100% Recyclable
	• Plastic Bag (0.1kg)	0%	
	• Recycled Paper (0.1kg)	90%	
	• Strapping	0%	
	• Tape (0.05kg)	0%	

# Assembly, Operating & Maintenance Instructions

## BURO METRO CHAIR - WITH/WITHOUT ARMS

Remove all items from the carton. Verify all pieces before assembly.

### STEP 1.

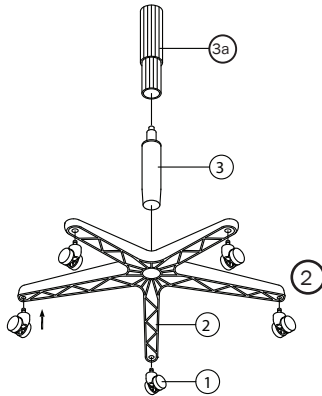

### STEP 2.

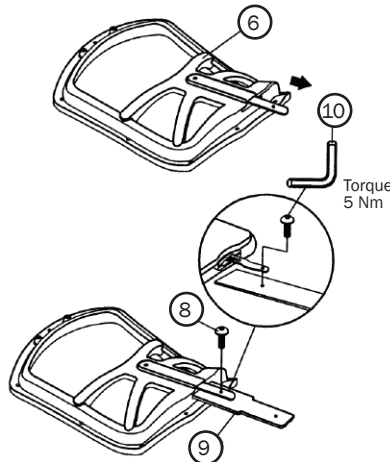

### STEP 3.

\*Arm assembly instructions for Metro Chairs purchased with arms only.

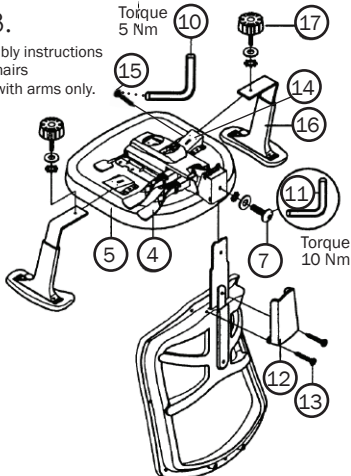

Mechanism pre-assembled to seat.



\*Line drawing of completed Metro Chair purchased with arms only.

## PART LIST

KEY	DESCRIPTION
1	5 Castors
2	1 Base
3	1 Gas Lift
3a	1 Gas Lift bellows (optional)
4	1 Mechanism
5	1 Seat
6	1 Backrest
7	1 Backrest Tight Screw & Washers
8	1 Backrest Screw
9	1 Backrest Post
10	1 M5 Size Allen Wrench
11	1 M6 Size Allen Wrench
12	1 Backrest Post Bellow
13	2 Backrest Post Bellow Screw
*14	2 Armrest brackets
*15	8 Armrest screws
*16	2 Armrest
*17	2 Arm Width Adjustment Knob & Washers

\*Parts required for Metro chairs purchased with arms only.

## FOAM & UPHOLSTERY SPECS\*

### FOAM

Flame Resistance: Ca117 Section A Part I & Section D Part II

### UPHOLSTERY

Flame Resistance: Ca117 Section E Class I

\*This applies only to standard Buro stock. Any customer specified upholstery may not meet these specifications.

## MECHANISM OPERATING INSTRUCTIONS

IMPORTANT NOTE: Do not operate the mechanism levers unless properly seated in the chair.

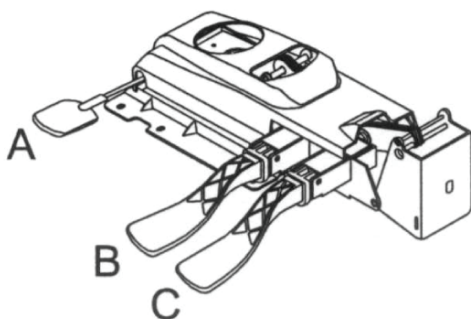

- A Pneumatic seat height adjustment
- B **Seat angle adjustment:** Seat angle adjusts independently with a single lever
- C **Backrest angle adjustment:** Back angle adjusts independently with a single lever

## RECOMMENDED SEATING POSITION & ADJUSTMENTS:

- Sit in the chair, adjust the seat tilt so that it is approximately horizontal or inclined slightly forward, to allow an angle greater than 90° at the knees and the hips.
- Adjust the seat height so that your feet are resting flat on the floor. For good circulation, your lower legs should form a 90° angle with the floor, with your feet taking the weight of your legs.
- Adjust the backrest tilt function accordingly, to give your back firm support while sitting upright.
- Adjust the height of the backrest to give support to the lumbar region of your back.
- Your forearms should be close to horizontal as possible when working at a desk.

## PREVENTATIVE MAINTENANCE & WARNING!

- Use this product only for seating one person at a time.
- Do not use this chair as a step stool/ladder.
- Do not sit on any part of the chair except the seat.
- Do not use this chair on uneven floor surfaces.
- Do not interfere with the operating of the gas lift.
- Do not use chair unless all bolts, screws and knobs are tight. At least every six months check all bolts, screws and knobs to ensure they are tight.
- If any parts are missing, broken, damaged or worn do not use the product until repairs are made using factory authorised parts.
- Dispose of packaging properly.
- Plastic bag is not a toy.
- Do not use plastic bag as a head covering as it may cause suffocation.
- Failure to follow these warnings could result in serious injury.